

RUTA DEL PEREGRINO

Category: territorial
Location: Jalisco, México
Surface: 117km
Project Year: 2011

*Collaborative Master Plan by Tatiana Bilbao, Derek Dellekamp and Rozana Montiel
Projects: Gratitude Open Chapel by Tatiana Bilbao and Derek Dellekamp Arquitectos
Void Temple by Rozana Montiel and Derek Dellekamp Arquitectos



dms 20°34'41.1"N / 104°13'33.0"W
elevation 1,635 m / 5,364 ft

dms N/A
elevation 1,500 m / 4921 ft

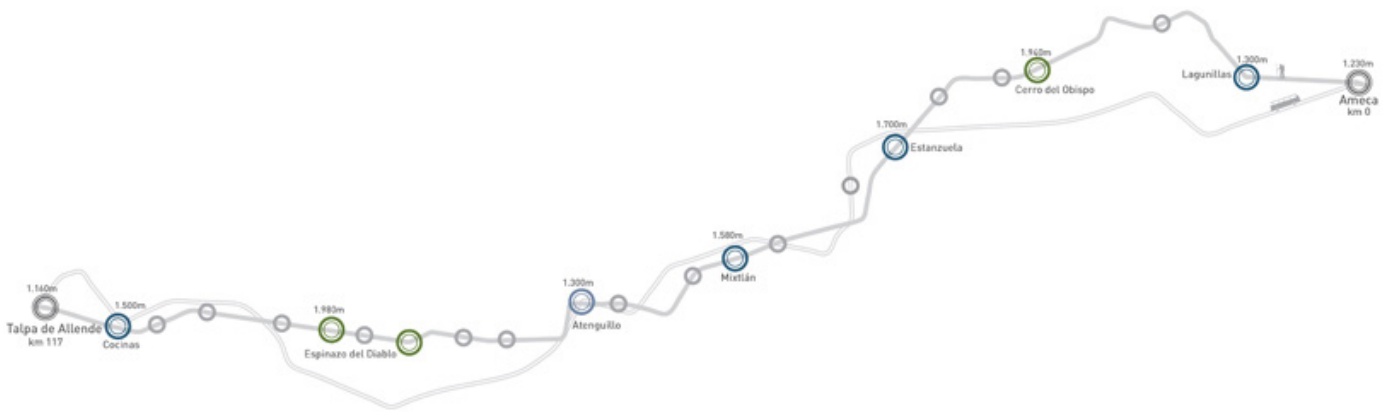

DELLEKAMP PERIFÉRICA SANCTUARY	ELEMENTAL LOOK OUT POINT	HHF LOOK OUT POINT	LUIS ALDRETE SHELTER	TATIANA BILBAO SANCTUARY	AI WEI WEI FAKE DESIGN SANCTUARY	CHRIST & GANTENBEIN LOOK OUT POINT	BILBAO DELLEKAMP GRATITUDE OPEN CHAPEL	GODOYLAB SERVICE AREAS

10) Masterplan of each intervention

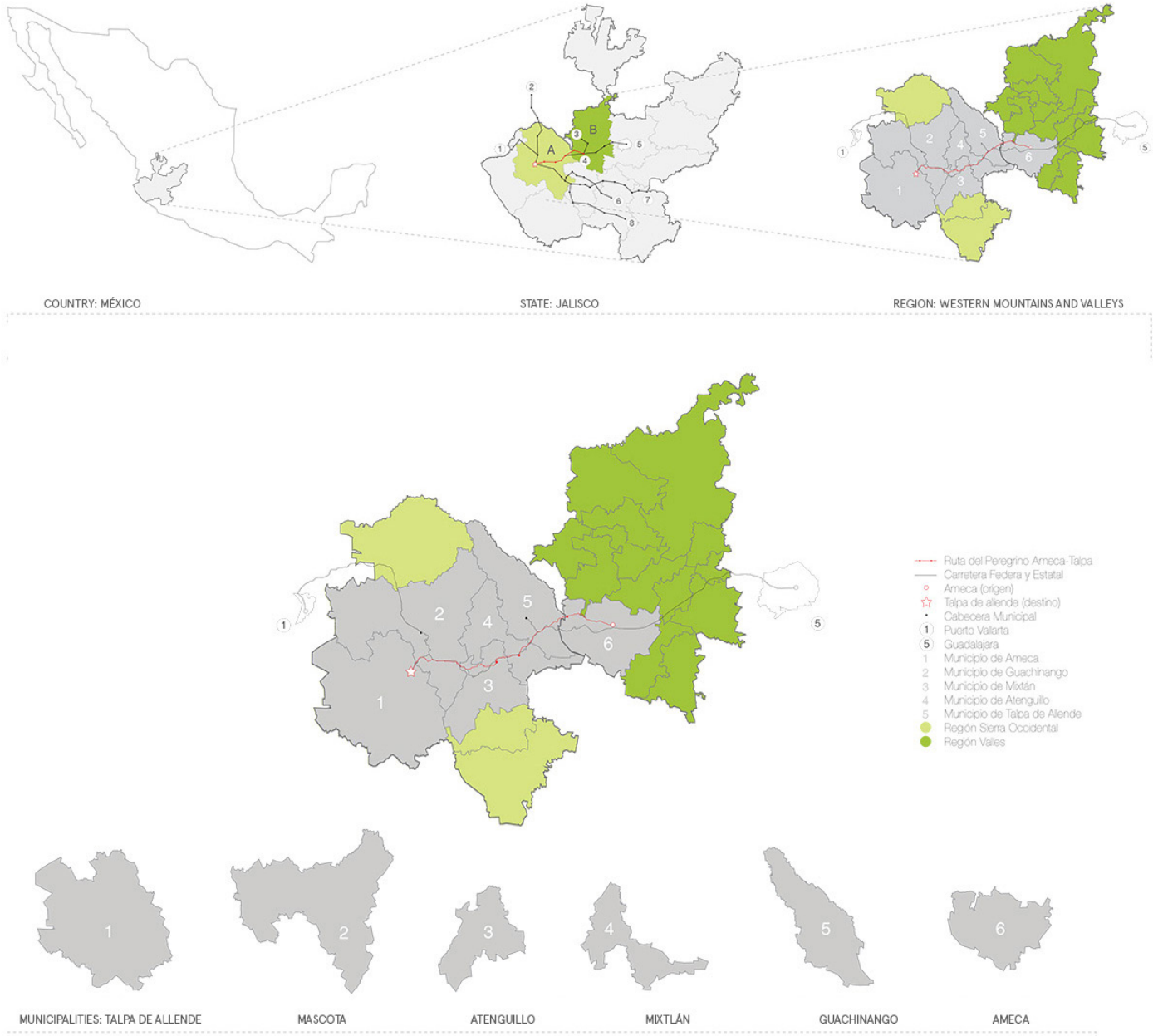

Every year approximately two million people come from different states of Mexico walk through the 117 km mountainous route of Jalisco, starting from the town of Ameca, ascending to el Cerro del Obispo, crossing the peak of Espinazo del Diablo to descend to its final destination in the town of Talpa de Allende to meet the Virgin of Talpa. This religious routes ranges approximately 2000 m above sea

level. Occurred since the 17th century, the pilgrims demonstrates their faith through concurring the tough journey with penitence. This journey in itself becomes a sacrifice and a ritual of purification.

The project consists of a series of interventions dotted along the historical route, aiming to provide better condition better condition for the pilgrims, at the same time also generates social and economic

profits to the surrounding area. Integrated infrastructure, iconic architecture and sculptures embeded in the religious ritual also brings together a broader audience. Tatiana Bilbao designed the systematic masterplan as the framework, and also two of the landmarks along the route. As each site fosters a dialog, they also intertwine into the lager vision of an ecological corridor beyond religious.

TOPOGRAPHIC PLAN

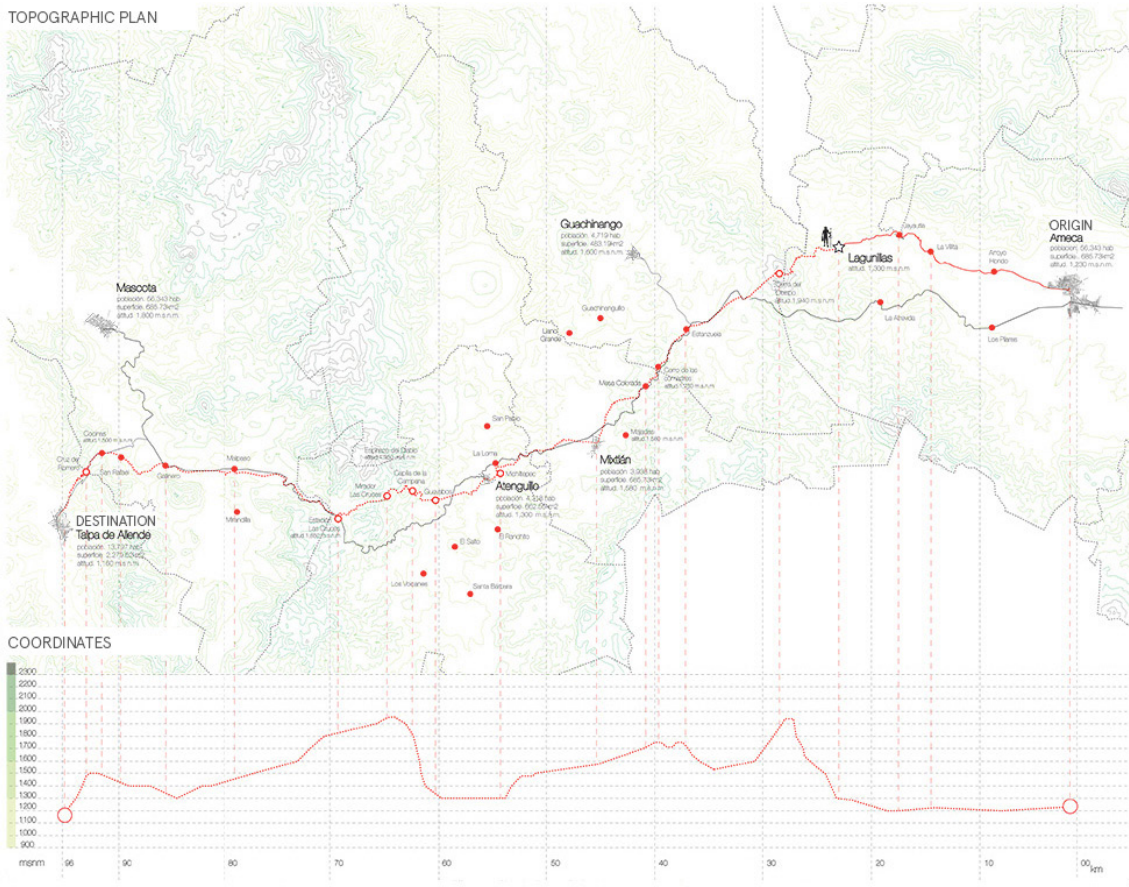

Ubicación de Sitios de Intervención

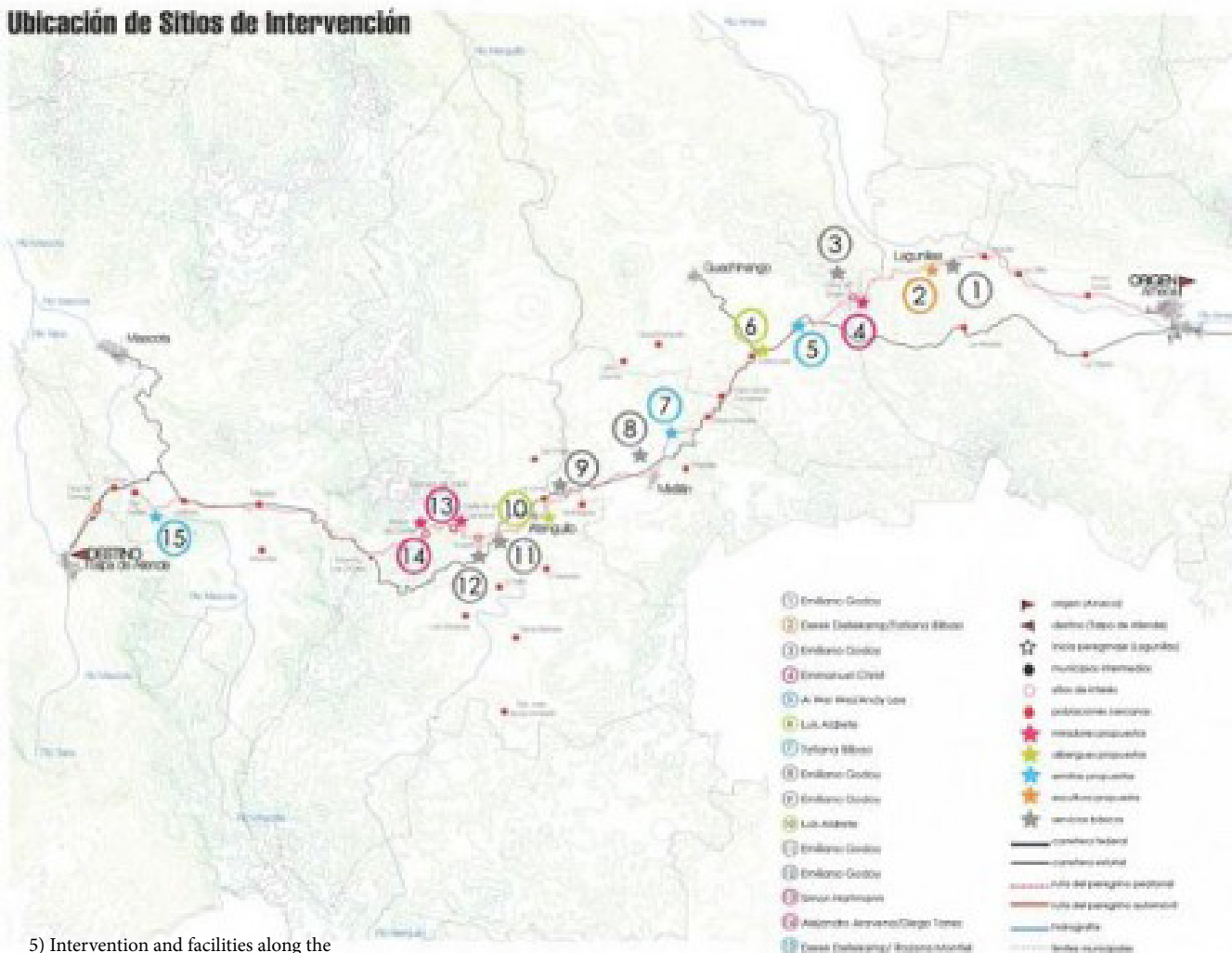

5) Intervention and facilities along the route

2) Aerial view



Near the starting point of the route is the Bishop Hill (Cerro del Obispo). Inspired by the sky outline of the landscape, Tatiana Bilbao with Dellekamp Architects design the Gratitude Open Chapel. A symbolic temple of four concrete slabs forms an abstracted cross in the sky.



6) , 7), View of the chapel



9) Site plan



8) Pilgrim and the chapel



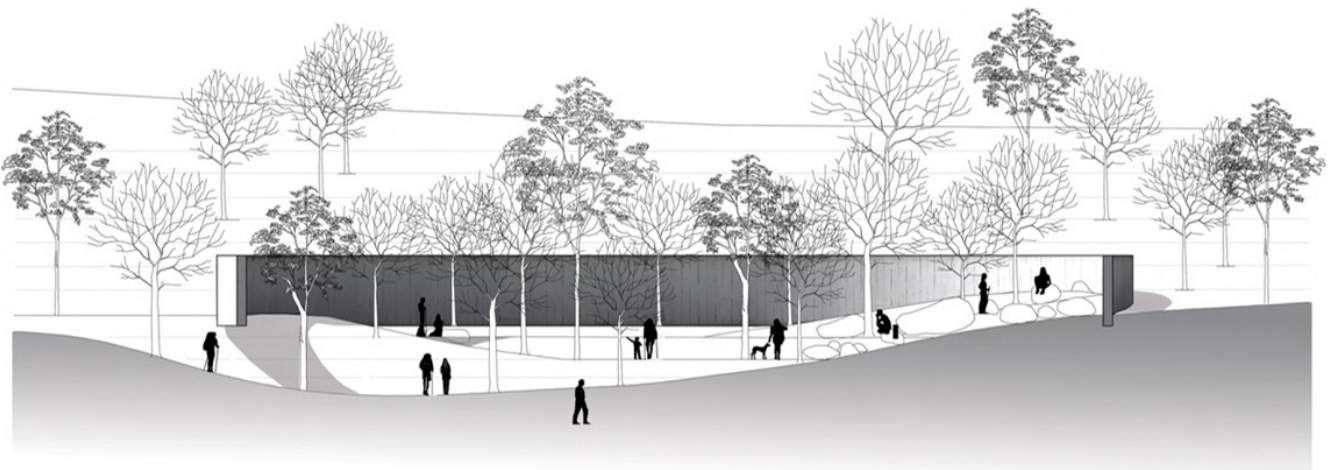
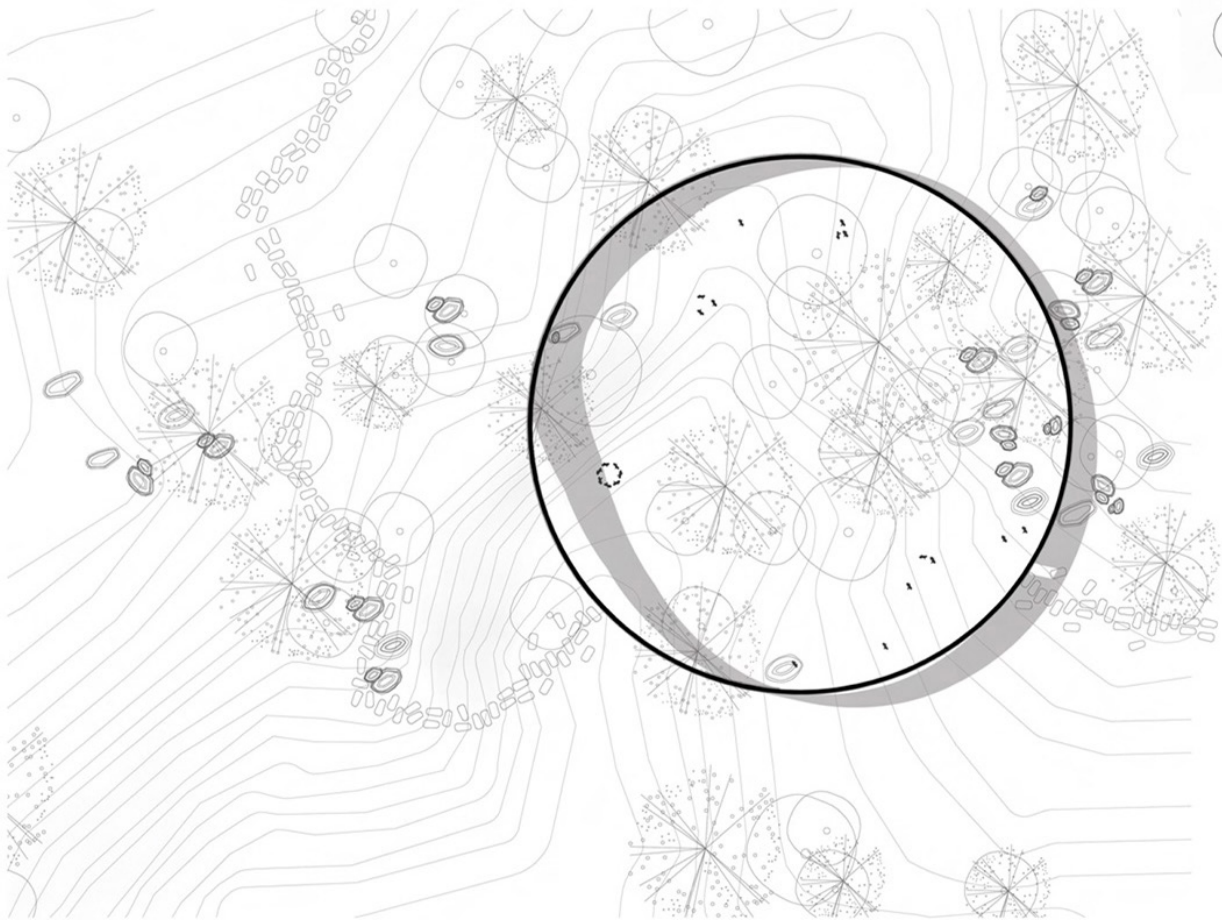

Void Temple, designed by Dell-ekamp Arquitectos and Rozana Montiel, a 40m diameter circle suspended 3m high blends into the pin woods and topography of the site. As a temple, it delimitates a space for contemplation with intimate relationship with nature.

