

ANA ELVIRA VELEZ & LORENZO CASTRO

JARDÍN BOTANICO MEDELLIN

Category: parks / plazas
Location: Medellin, Colombia
Surface: 28,515 sqm
Project Year: 2006



dms 6°16'14.0"N / 75°33'47.8"W

elevation 1,487 m / 4,878 ft

“A mineral void that is diluted into a vegetated field : a metaphor of urban intervention sewing the enclosed Medellin Botanical Garden with the rest of the city.”

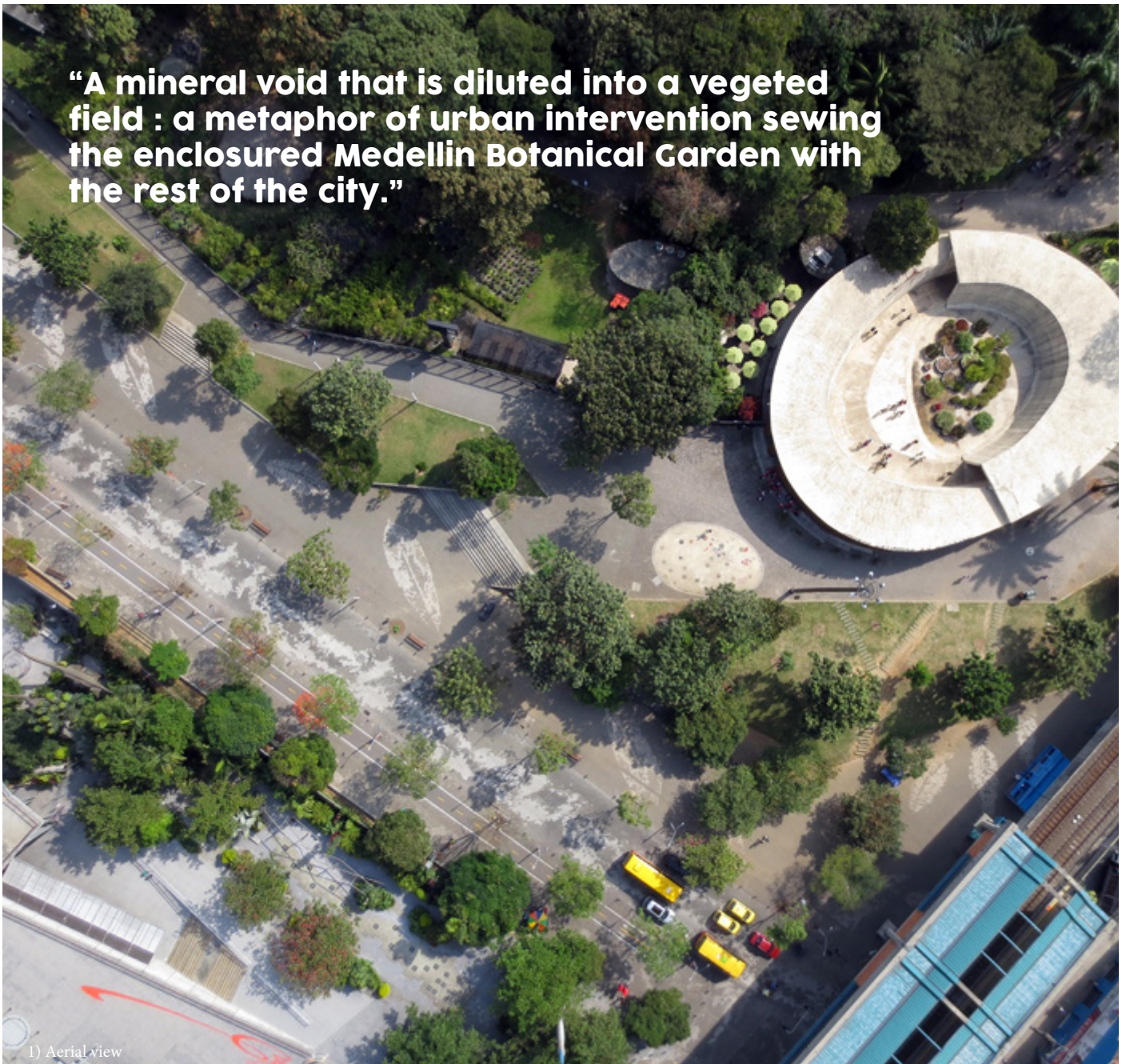

The Botanical Garden of Medellin is located at a strategic site, once segregated, underwent urban renewal to improve the social condition. Historically in Medellin, the city's botanical gardens was surrounded by a fortress-like concrete wall more than 10 feet tall and covered by graffiti, isolating the garden's planting and aromas from the poverty and violence in the surrounding neighbourhood. As part of a larger city-wide effort to improve the public space, the

botanical garden underwent renovation to knock down the barrier - "the fall of the wall" - and add new public urban space surrounding the botanical garden's collection core. The redesign of the urban edge includes all edges of the botanical garden, the construction of new access, a cafe, a shop and a nursey, commissioned to Lorenzo Castro and Ana Velez.

The new enclosure was constructed with metal mesh panels and metal frames, with

different heights accommodating the topography, and generate a dynamic image responding to the various levels on site. Painted in black, the fence now provides 100% transparency between the inside and outside of the site, and welcomes pedestrians to enjoy the garden through colour and amour without entering the garden.

The peripheral edge is defined by a series of rings which forms a new surface of 22,000m² for public use.



2) View from the street

The outer ring connects bike lanes, pedestrian sidewalks and parking space, while the internal rings links verandas and garden paths, establishing primary and secondary access. Utilizing a bold pattern, the new surface provides continuity and a welcoming message to the public without even entering the garden. Street furniture, platform, benches and shading trees are added to frame this new image and invites the public to use the site spontaneously.

In addition, the entrance pavilion is positioned on the corner of Avenida Carabobo and raised above ground. The pavilion is defined by a podium as a lookout over the corner, highlights the access and connects to the squares,

terraces and surrounding public areas. The sculptural form marks it as a milestone for both the botanical garden and the city. It's a formal gesture to be recognized both from the city and towards the interior green.



3) Street furniture.



4) Undulating fence.

“The fence, because of its symbolic value, is seen as the first real statement of the site’s integration with the city.”



5) New urban edge surrounding the botanical garden.

DETALLE HOJA 1

GAMA COLORES ADOQUINES 0.10m x 0.10m

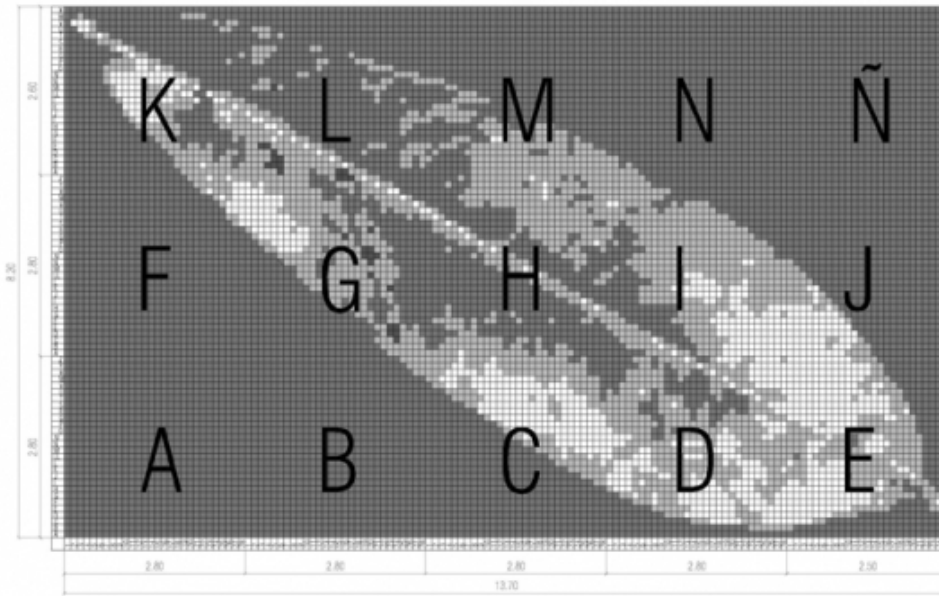

PLANTA HOJA 1
ESC 1:75

6) Pattern of the paving



7) Paving

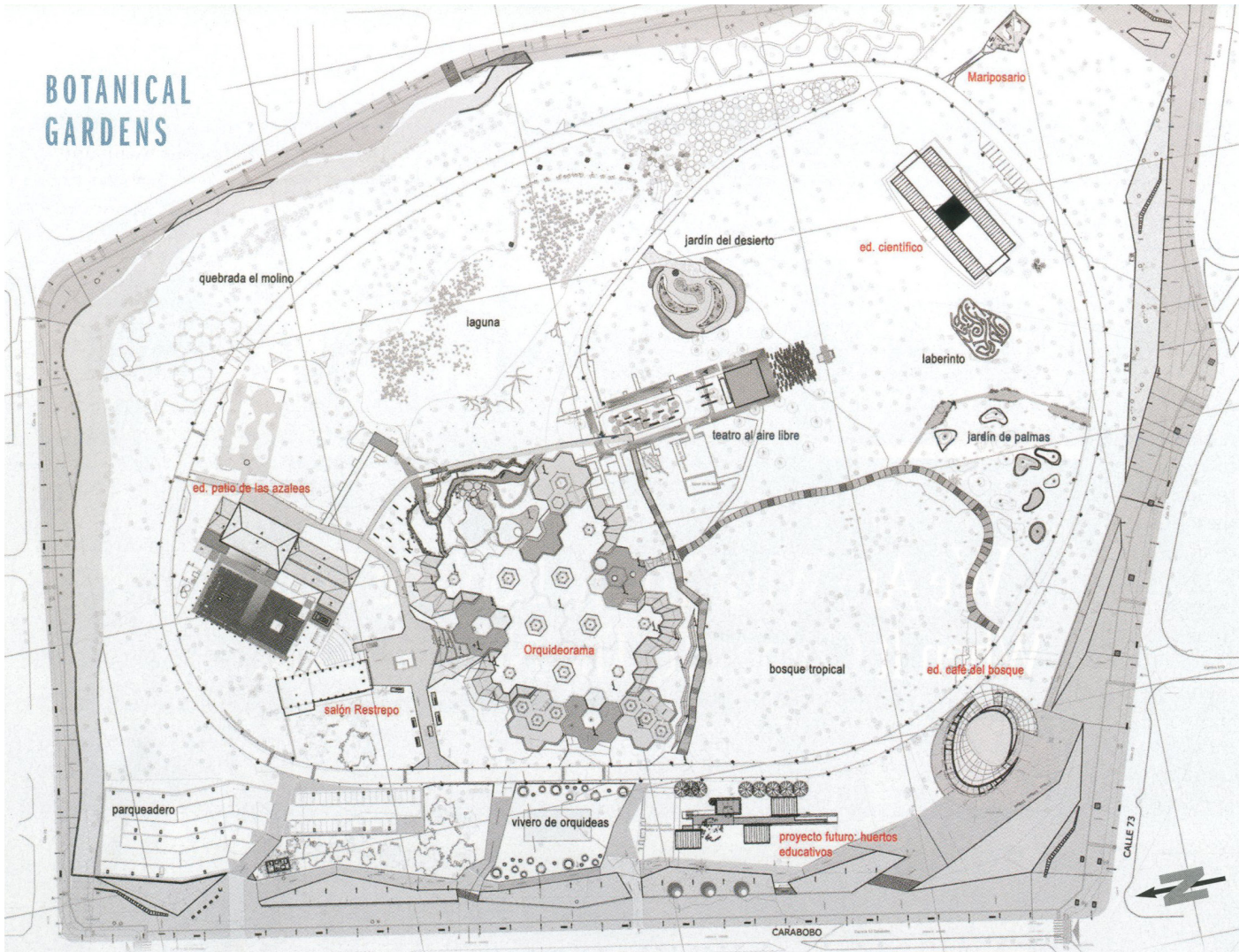

8) Overall plan of the Botanical Garden



9) Elevation of the fence

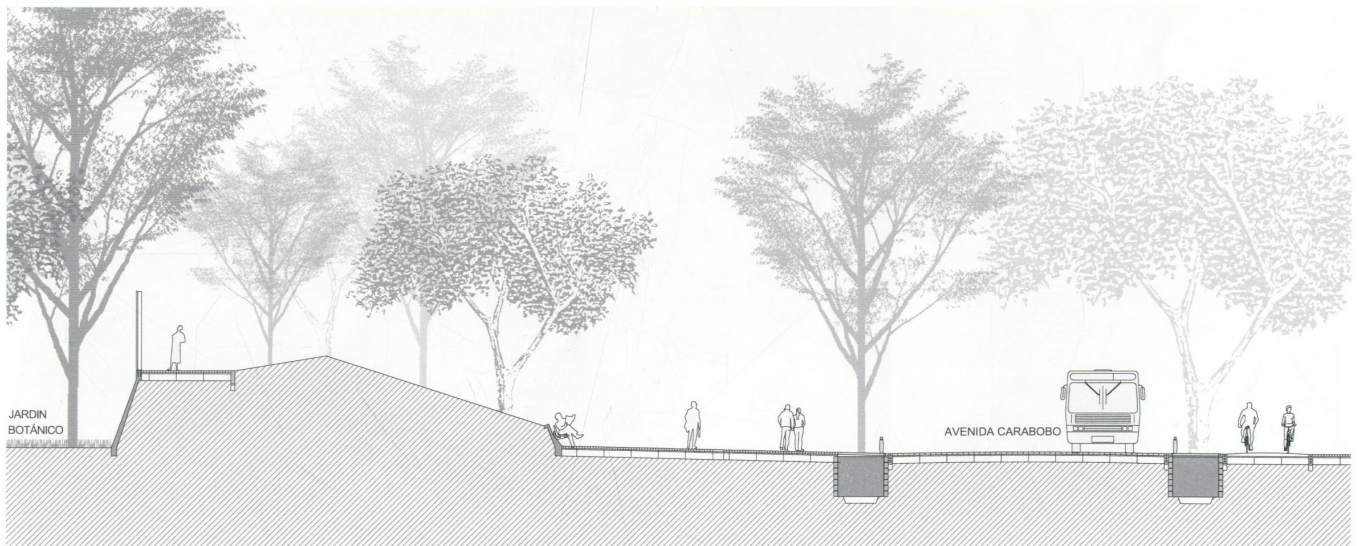

10) Section of urban edge

**“El café del Bosque is more than a building,
propose to create an rich atmosphere that
engages both the garden and the city”**



11) Jardín Botánico entrance + Café del Bosque



12) The void