

OPUS Oficina de Proyectos Urbanos
est. 2007

In association with LAUR-UPB
Medellin, Columbia

BIO 2030 METROPOLITAN PROMENADE

Category: Contemporary Master Plan
Location: Medellin, Columbia
Surface: 120 Ha
Project Year: 2011



across city scale
multiple elevations

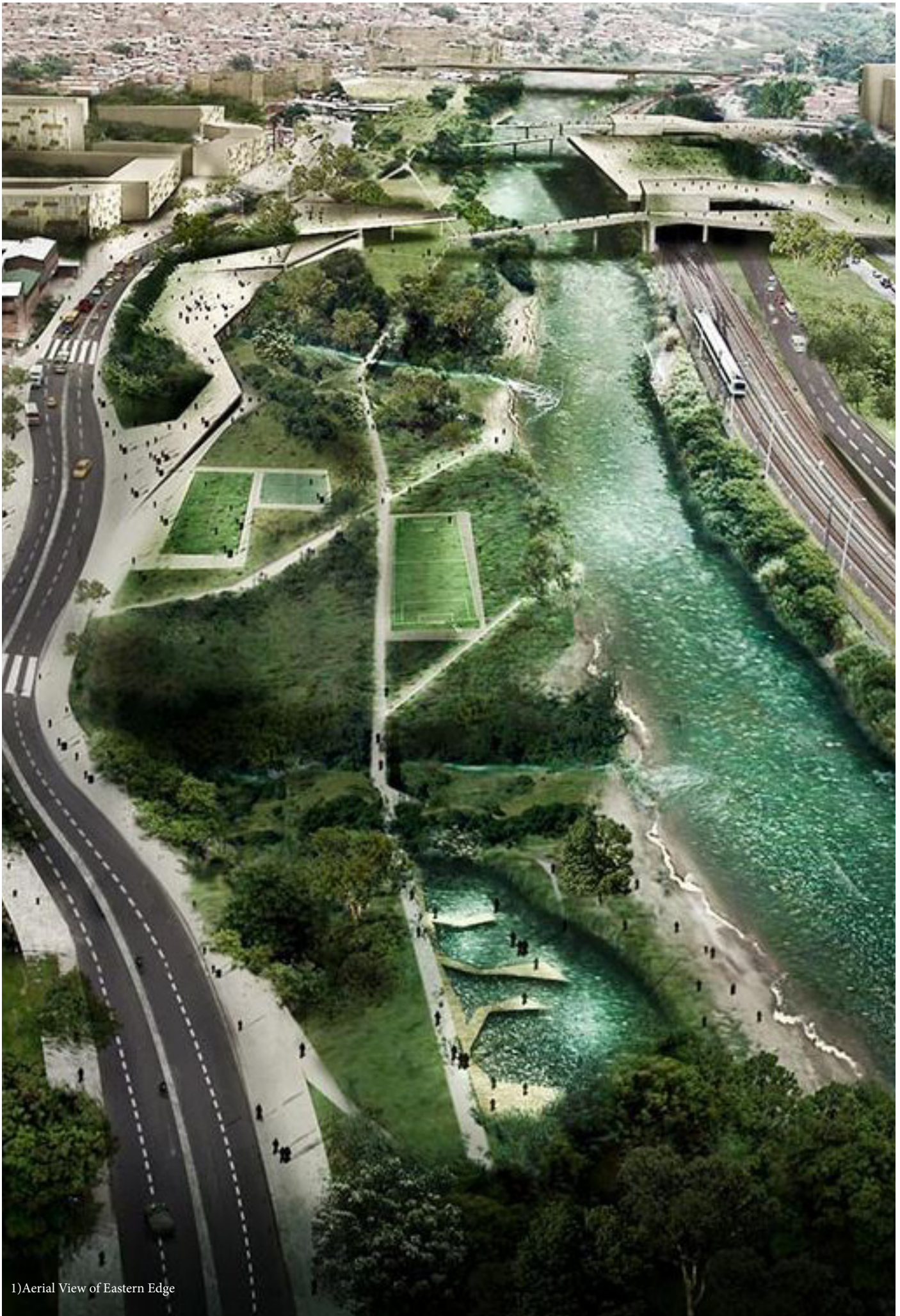

1) Aerial View of Eastern Edge

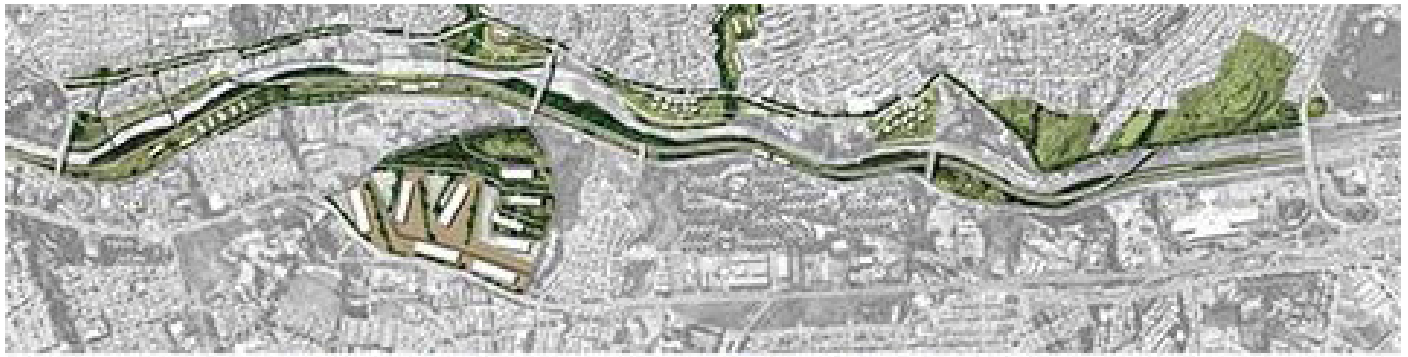

2) Stages of Implementation



3) Overall Vision Plan

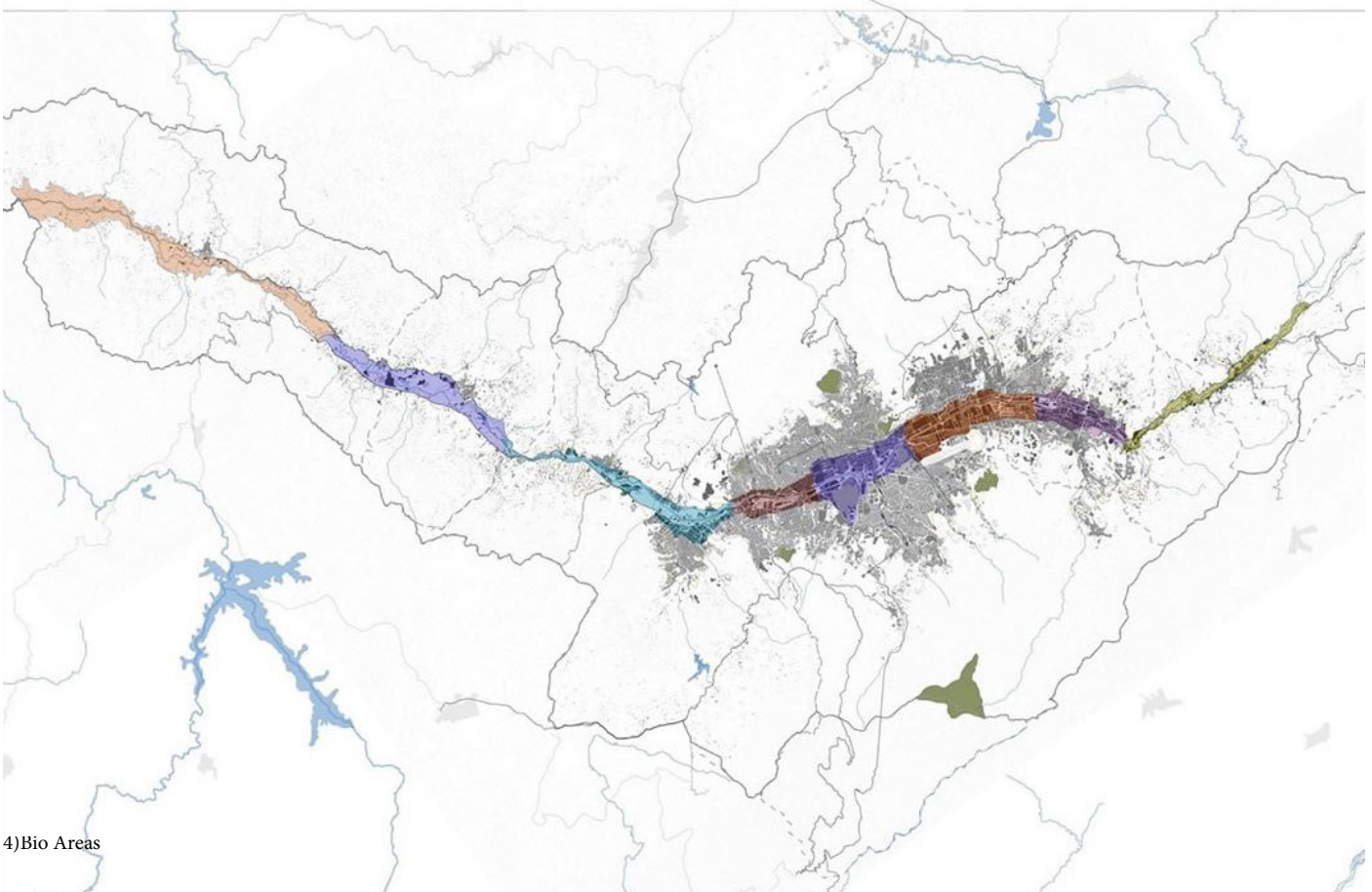

4) Bio Areas



5) Scope of Moravia-Bello



6) Proposed Subway Station

1. Estado actual

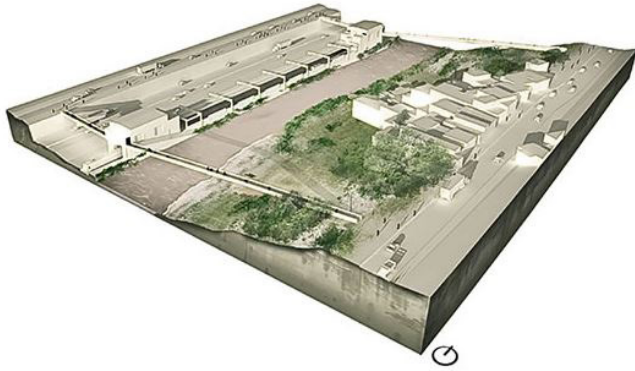

2. Propuesta de plataformas, nuevos equipamientos y parque de ronda

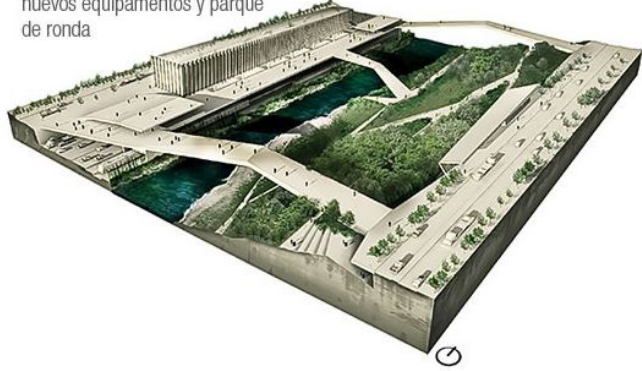

3. Parque de borde y mejoramiento integral de barrios



7) Transformation Schemes

SECCIONES URBANAS

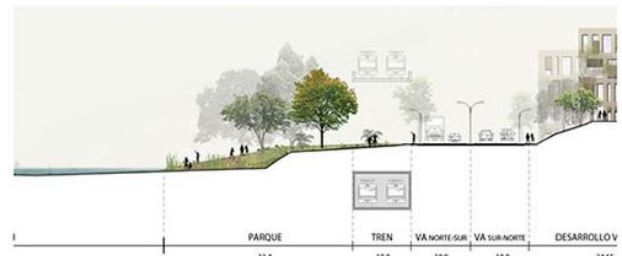
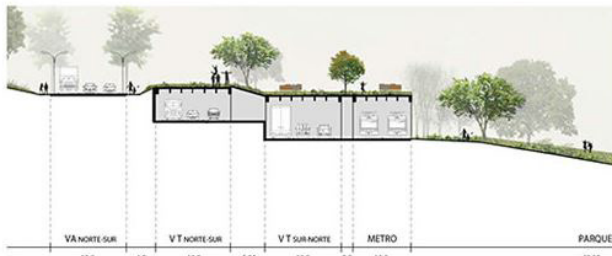
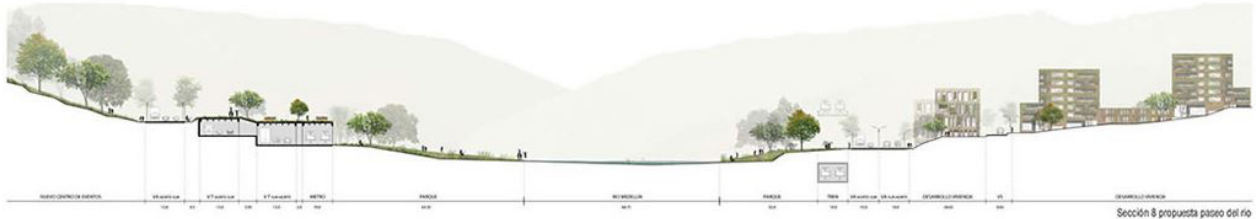
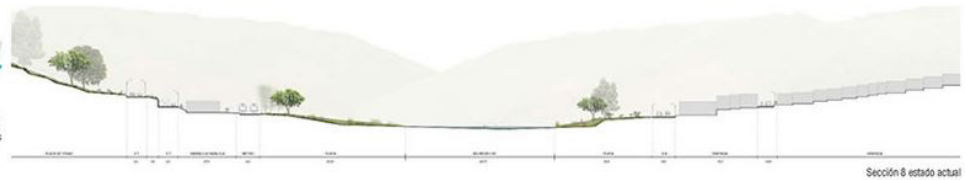
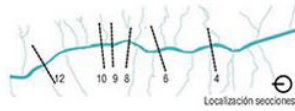

8) Urban Sections

1. Pendientes

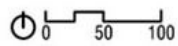
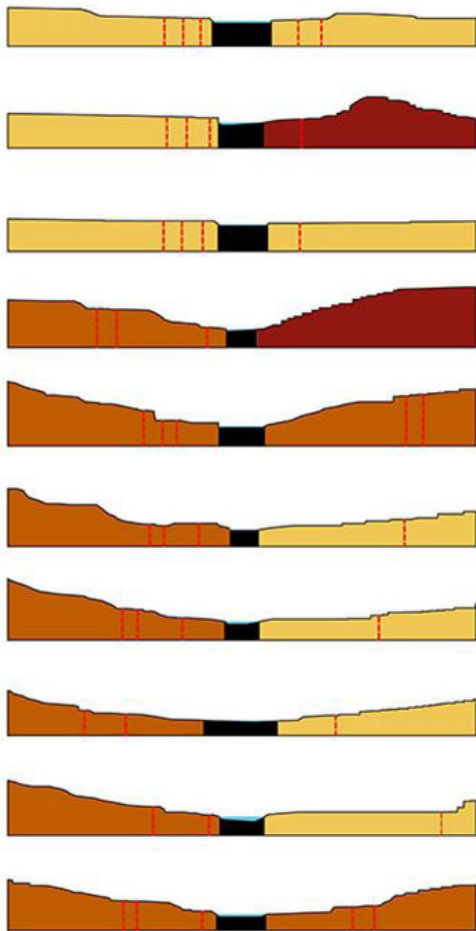

2. Cauce

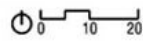
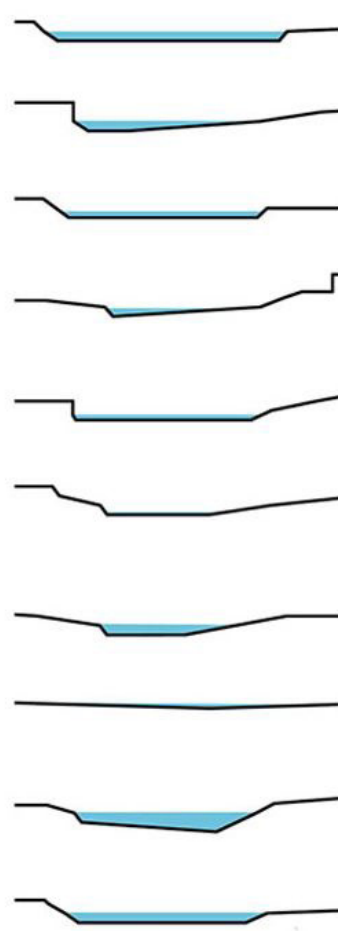

3. Áreas de oportunidad

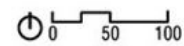
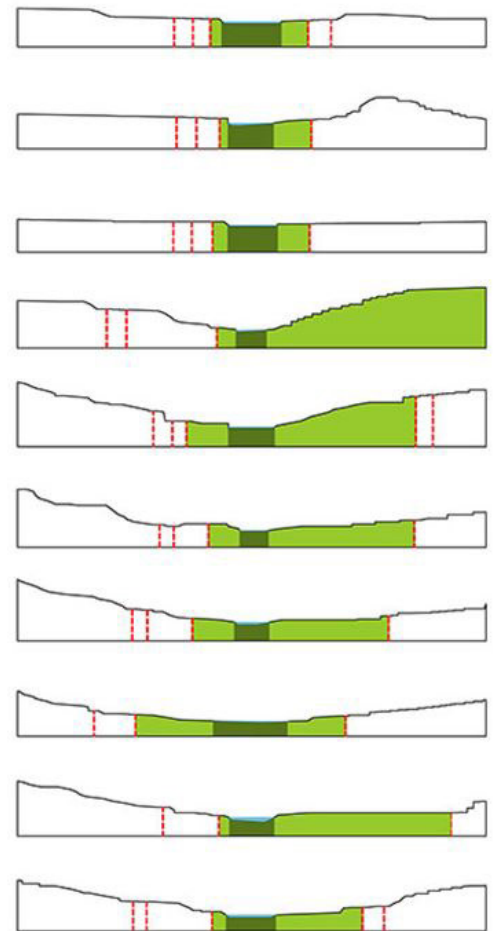

9) River Analysis Sections